



207 Waterloo Street

, Burton-On-Trent, DE14 2NQ

Offers in the region of £115,000



Burton's only "Legally Trained" Estate Agents are delighted to present to the market this three-bedroom property. This stunning home is situated close to shops and all local amenities and is within walking distance of the town centre, as well as easy access to nearby transportation links such as the A38 and the train station. This house is being sold CHAIN FREE.

This mid-terraced property is set over two floors. The ground floor briefly comprises a large reception room, a fitted kitchen, a conservatory and a family bathroom. On the ground floor, there are three good-sized bedrooms. Outside, there is a large, well-maintained garden.

The Vendors are "Legally Seller Ready". What do we mean by this term? The Vendors already have Solicitors instructed, contracts have been prepared, and searches have been requested on their home. The searches will be provided to any prospective buyer and their Solicitor ready to be used (saving 8 weeks). If you are a cash buyer ready to move in straight away or if you are buying with a mortgage, then merely your lender will provide a mortgage offer and you are ready to move in.



- LOUNGE 11'9" x 10'10" (3.60m x 3.32m)
- KITCHEN 11'9" x 10'10" (3.60m x 3.32m)
- CONSERVATORY 5'6" x 10'0" (1.69m x 3.07m)
- BATHROOM
- MASTER BEDROOM 14'11" x 10'4" (4.56m x 3.15m)
- BEDROOM TWO 14'11" x 10'4" (4.56m x 3.15m)
- BEDROOM THREE 6'0" x 10'8" (1.84m x 3.27m)

Area Map

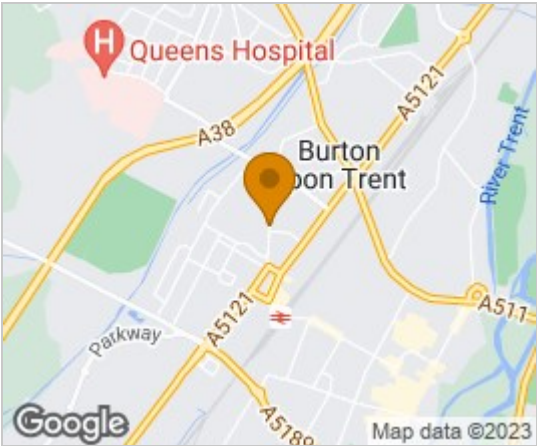

Floor Plans

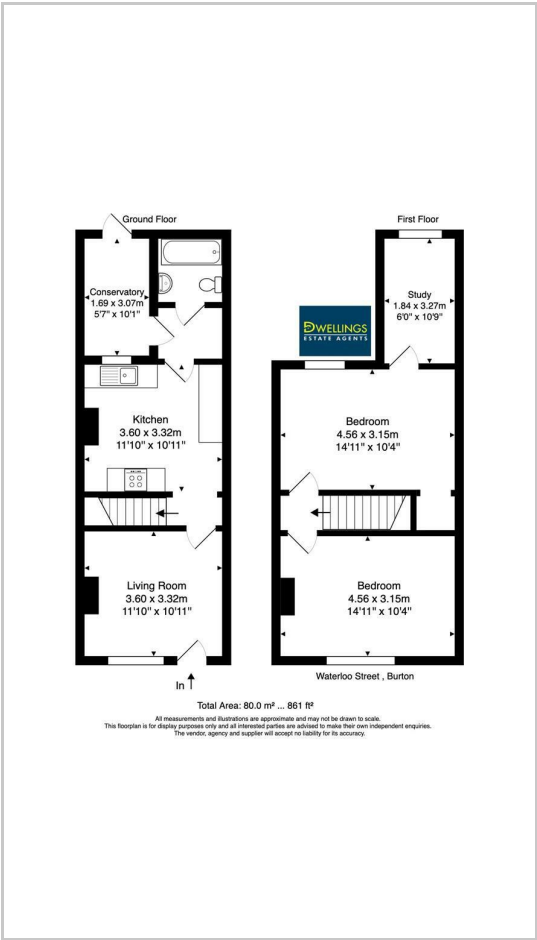

Energy Efficiency Graph

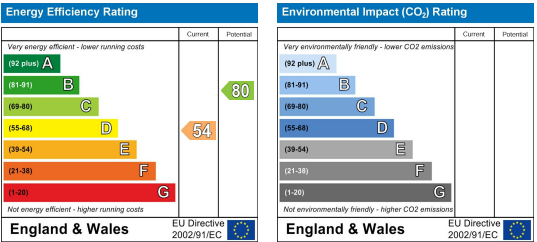

These particulars, whilst believed to be accurate are set out as a general outline only for guidance and do not constitute any part of an offer or contract. Intending purchasers should not rely on them as statements of representation of fact, but must satisfy themselves by inspection or otherwise as to their accuracy. No person in this firms employment has the authority to make or give any representation or warranty in respect of the property.